

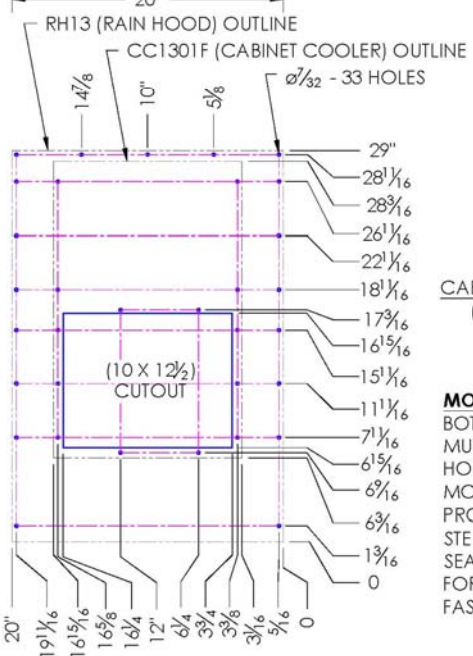

# CC1301F-RH13 & CC1301F-WL\*-RH13 COMPACT CABINET COOLER WITH RAIN HOOD MODEL

Model	Weight	Rating @ 20°C ΔT BTU / hr	Amps Current Draw at 115 volts AC	Fan Size	Dimensions-Inches (H x W x D)
CC1301F- RH13	32 lbs	4,850	0.98	2 x 6"	29 x 20 x 8

Efficiency: 71.0 Watts / °C ΔT based on average internal cabinet temperature.

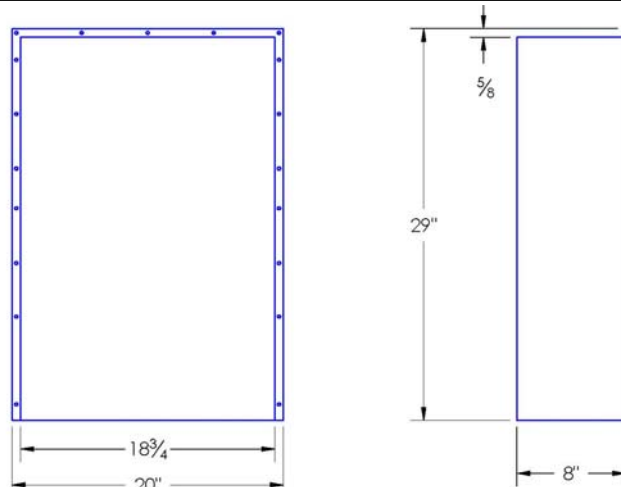

CABINET HOLE PATTERN  
(EXTERNAL VIEW)

**MOUNTING INFORMATION:**  
BOTTOM OF HOOD (AIR INLET)  
MUST BE AT LEAST 6" FROM A  
HORIZONTAL SURFACE.  
MOUNTING FASTENERS ARE  
PROVIDED 8-32 x 3/4" STAINLESS  
STEEL SCREWS & NUTS).  
SEALING WASHERS ARE PROVIDED  
FOR SEALING MOUNTING  
FASTENERS INSIDE YOUR ENCLOSURE.



Outside View



Inside View

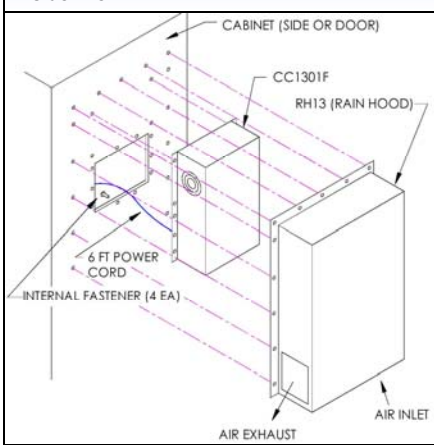

- SPECIFICATIONS**
- Unit and options are UL Listed (SA9567) for TYPE 3R or TYPE 4 environments.
  - CC1301F Rated cooling: 1,420 Watts at 20°C ΔT (71.0 W/°C, mounted to an uninsulated 72" x 36" x 24" cabinet.)
  - Cabinet cooler with hood design for surface mounting on outside of cabinet.
  - Housing and hood are aluminum (color is black). Stainless steel is available.
  - Equipped with mounting gasket to maintain the NEMA / TYPE 3R or 4 integrity of your cabinet.
  - Pressure tested to insure liquid tight seal.
  - \* 7. Optional "WET LOCATION FAN" (-WL) is required for TYPE 4 (HOSE DOWN).
  - Internal 6-ft. power cord with 3-prong plug is standard for AC powered units.
  - Available with VAC (115 & 230) and VDC (12, 24, & 48) fans. DC powered units include junction box, consult website.
  - For Vertical mounting only (as shown).
  - Optional: inlet air-filter kit available upon request.
  - For design, quote, and sizing assistance: call (888) 754-6329.

Subject to change without notice.



**Thermal Solutions**  
**NOREN**  
Products Incorporated

**Pelmar Engineering Ltd.**  
Tel. (888) 754-6329  
sales@pelmareng.com  
www.pelmareng.com

CC1301F-RH13 & CC1301F-WL\*-RH13

CCS-PBD-7.2.2-883348-A