

CC4000F & CC4000FP* COMPACT CABINET COOLER AIR-TO-AIR FLUSH-MOUNT MODEL

Model	Weight	Rating @ 40°C ΔT BTU / hr	Amps Current Draw at 115 volts AC	Fan Size	Dimensions-Inches (H x W x D)
CC4000F	60 lbs	13,700	2.4	8 x 6"	58 x 13-7/8 x 7-7/8

Efficiency: 200.0 Watts / °C ΔT based on average internal cabinet temperature.



Outside View

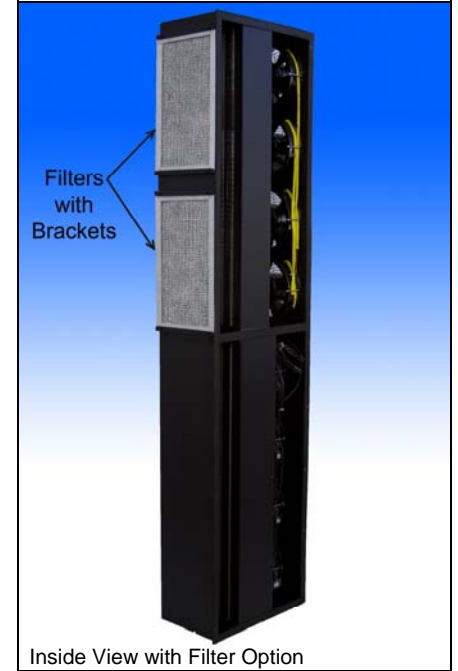

Inside View with Filter Option

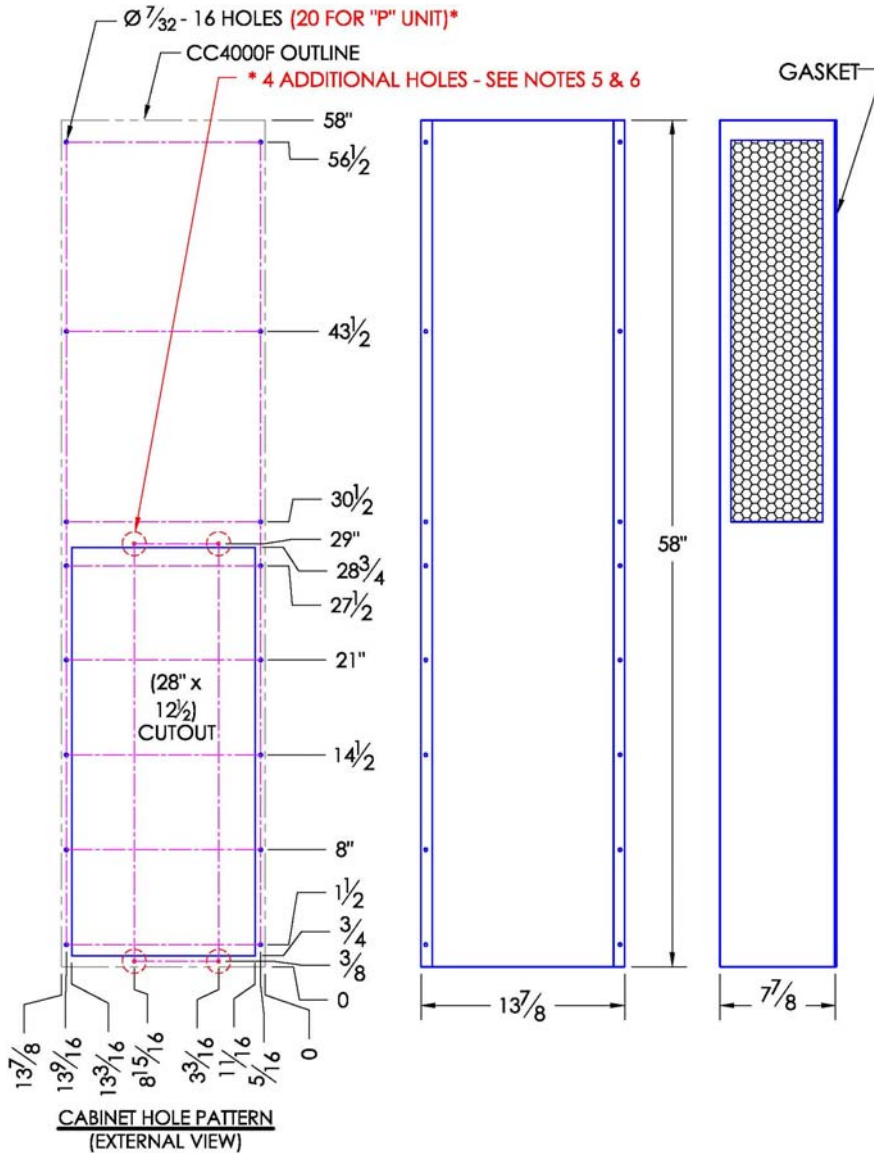

SPECIFICATIONS

1. Rated cooling: 4,000 Watts at 20°C ΔT (200.0 W/°C, mounted to an uninsulated 72" x 36" x 24" cabinet).
2. Designed for surface mounting on the outside of cabinet.
3. Housing is aluminum (color is black). Stainless steel is available.
4. Equipped with mounting gasket to maintain air tight seal.
5. "P" unit is pressure tested to assure water tight seal.
6. Four additional mounting holes are for "P" unit only.
7. Available with VAC (115 & 230) and VDC (12, 24, & 48V) fans.
8. Unit may be mounted vertically (as shown) or horizontally.
9. Optional: inlet air-filter kit available upon request.
10. For design, quote, and sizing assistance: call (888) 754-6329

Subject to change without notice.



Proudly made in USA



ISO 9001:2008
FM 554949



Pelmar Engineering Ltd.

Tel. (888) 754-6329
 sales@pelmareng.com
 www.pelmareng.com

CC4000F & CC4000FP*

CCS-PBD-7.2.2-883313-B