

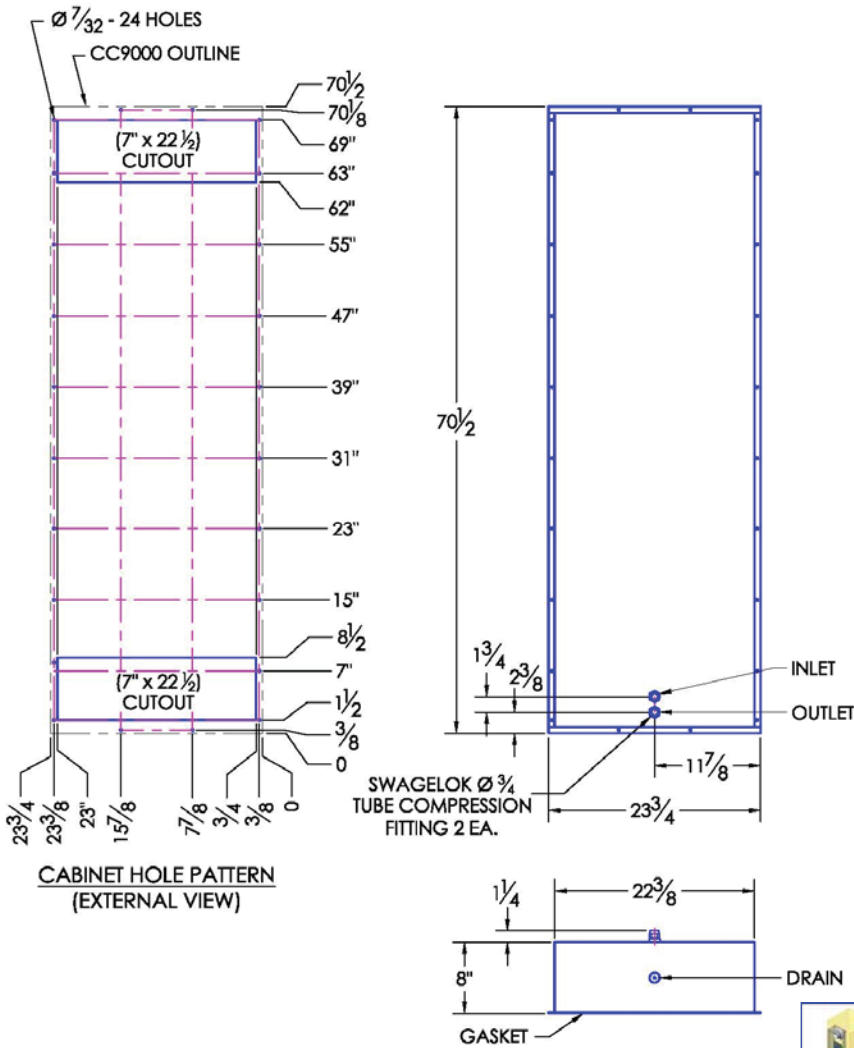

# CC9000 & CC9000P\* COMPACT CABINET COOLER AIR-TO-WATER FLUSH MOUNT MODEL

Model	Weight	Rating @ 40°C ΔT BTU / hr	Amps Current Draw at 115 volts AC	Fan Size 8 x 6"	Dimensions-Inches (H x W x D)
CC9000	79 lbs	57,000	2.4	8 x 6"	70-1/2 x 23-3/4 x 8

Efficiency : 417.0 Watts / °C ΔT based on average internal cabinet temperature.



[SEE HOW CABINET COOLERS WORK - CLICK HERE >>](#)

## SPECIFICATIONS

1. RATED COOLING: 16,680 WATTS (MOUNTED TO AN UNINSULATED 72" x 36" x 24" CABINET WITH 2 GPM OF WATER AT 20°C, 40°C AMBIENT AIR AND 60°C CABINET AIR TEMPERATURE).
2. DESIGNED FOR SURFACE MOUNTING ON THE OUTSIDE OF CABINET.
3. ALUMINUM HOUSING (COLOR IS BLACK) OR STAINLESS STEEL.
4. EXTERNAL WATER INLET & OUTLET CONNECTIONS.
5. EQUIPPED WITH MOUNTING GASKET TO MAINTAIN AIR TIGHT SEAL.
- \* 6. "P" UNIT IS PRESSURE TESTED TO ASSURE WATER TIGHT SEAL.
7. AVAILABLE WITH 115VAC, 230VAC, AND 12VDC, 24VDC, 48VDC FANS.
8. VERTICAL MOUNTING ONLY.
9. COOLANT WATER PRESSURE: THIS UNIT IS PRESSURE TESTED TO 100 PSI. SAFE WORKING PRESSURE IS 60 PSI.
10. RECOMMENDED COOLANT FLOW RATE (GALLONS PER MINUTE): 2 GPM
11. **FOR DESIGN, QUOTE, AND SIZING ASSISTANCE : CALL (888) 754-6329.**



Outside View



Inside View



[Pelmar Engineering Ltd.](#)

Tel. (888) 754-6329  
sales@pelmareng.com  
www.pelmareng.com

CC9000 & CC9000P\*

CCS-PBD-7.2.2-883322-A

Subject to change without notice.